

# CRUISING ON THE MEKONG RIVER

## AVALON SAIGON<sup>SM</sup> (2018)

Passengers: 36 | Crew Members: 24 | Length: 195 ft. | Decks: 2 | Suites: 18 (245 sq. ft.)

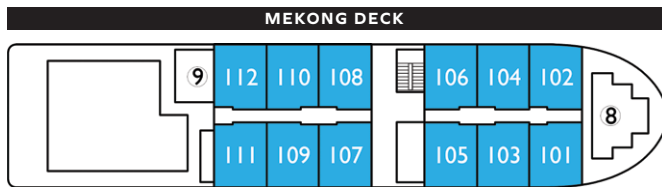
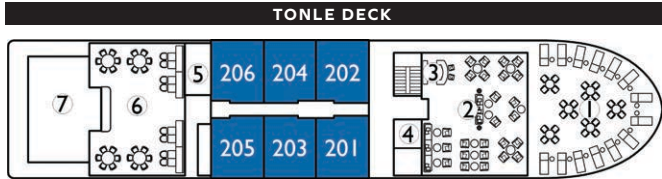
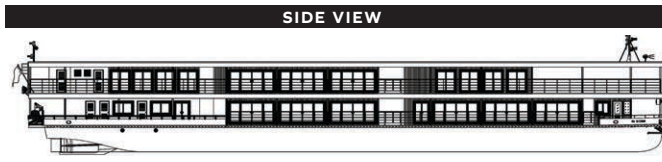

- |  |                      |                     |
|--|----------------------|---------------------|
| 1 Open-air observation lounge with premium lounge chairs | 2 Panorama Lounge    | 6 Dining Room       |
|  | 3 Bar                | 7 Galley            |
|  | 4 Reception          | 8 Navigation Bridge |
|  | 5 Spa treatment room | 9 Fitness Center    |

- CAT. A** Tonle Deck | Panorama Suites
- CAT. B** Mekong Deck | Panorama Suites

### SHIP AMENITIES

- Air-conditioned Panorama Lounge
- Open-air observation lounge with shade system & premium lounge chairs
- Spacious, open-seating Panorama Dining Room
- Bar serving premium spirits, wine & complimentary coffee, tea, soft drinks, and local beer/spirits throughout the day
- Complimentary Wi-Fi access in the lounges (where signal is available)
- Spa treatment room
- Fitness Room
- Library and games
- Non-smoking staterooms & ship interior



### PANORAMA SUITES<sup>SM</sup>

245 SQ. FT.  
TONLE & MEKONG DECKS  
CATEGORY A & B

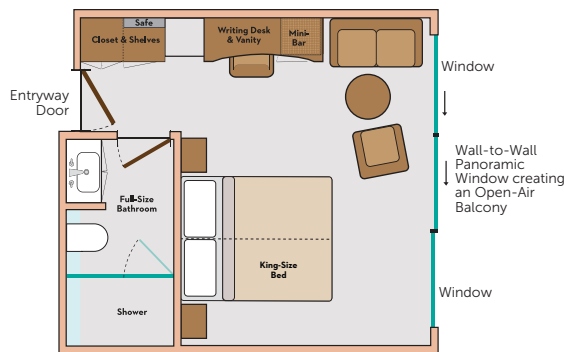

### AMENITIES

- Comfort Collection Beds<sup>SM</sup>, featuring premium mattress covers
- Egyptian super-combed cotton linens, blankets & European-style duvets
- Soft & firm pillows
- Choice of bed configuration (two twins or one king)
- Nightly turn-down service
- Bedside tables with reading lamps
- 14' Wall-to-Wall Panoramic Window that opens to create a large Open-Air Balcony<sup>SM</sup>
- Large private bathroom featuring full shower with glass door, hairdryer, and premium bath products
- Spacious closets with shelves for ample storage
- Easy under-bed luggage storage
- Writing desk/vanity with mirror & comfortable chair
- In-house telephone
- Bathrobes & slippers
- Complimentary water
- In-room safe
- Individual climate control

